

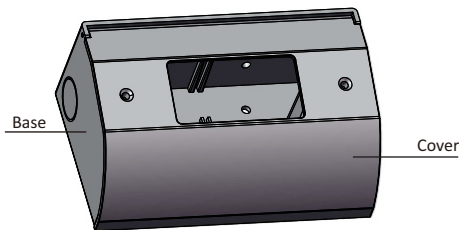

## Product Diagram



## Tools Requirements

- Phillips screwdriver
- Slotted screwdriver
- Level and ruler

## Accessories

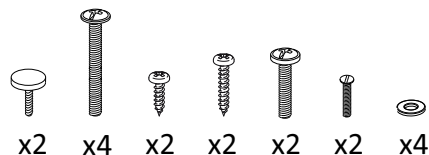

## Safety Guide

### IMPORTANT:

- Read all instructions before installing the UCB box.

### PRIOR TO INSTALLATION:

- Contact a local electrical inspector to make sure that this product meets or exceeds all local electrical codes, as electric codes may vary by location.
- Make sure there is adequate space to install.
- **Risk of Electric Shock or Death.** Ensure to disconnect and turn off all power sources.  
**\*\*\*LEW ELECTRIC FITTINGS ACCEPTS NO RESPONSIBILITY IF ABOVE AND BELOW CONDITIONS ARE NOT MET/FOLLOWED\*\*\***
- For indoor use only.
- This product is designed for cabinets and similar surfaces.
- All non GFI units must be wired to a GFCI circuit breaker if being installed in any area where the potential for water is present.
- Only licensed, insured, and bonded electrical contractors should install the UCB series.
- Any attempt to alter this product in any way may cause electrocution.

## Installation

1. Remove the knockouts as necessary to accommodate back-feed wiring (Fig. 1):

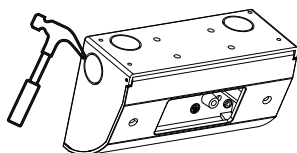

Fig. 1

2. The UCB box supports cabinet mounting or wall mounting, with horizontal or vertical orientation. Please choose the method that suits your needs. For details, refer to the information on the right.



### Cabinet Mounting

1. Select either horizontal (Fig. 2) or vertical (Fig. 3) mounting orientation that suits your needs.
2. Use the provided template to drill holes in the cabinet with a 3/16" diameter drill bit.
3. Secure screws with washers.

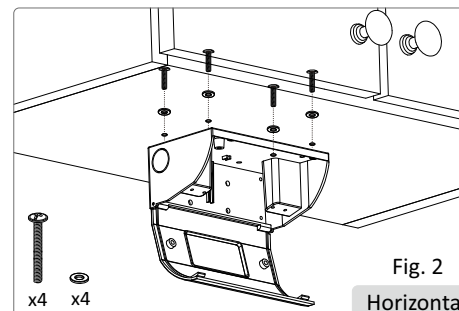

Fig. 2

Horizontal

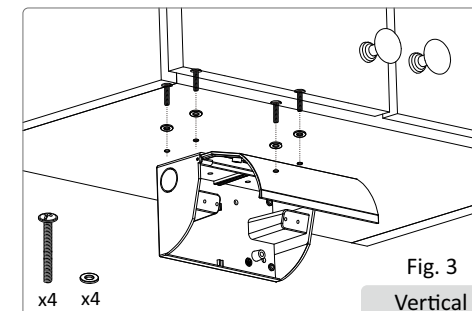

Fig. 3

Vertical

### Wall Mounting

1. Select either horizontal (Fig. 4) or vertical (Fig. 5) mounting orientation that suits your needs.
2. Optional step: If necessary, insert the supplied level adjustment screws.
3. Use 1" screws to attach to the wall.

**Important:** Screws must go into a stud, or wall anchors **MUST** be used.

4. Use 1/2" screws to secure the cabinet.

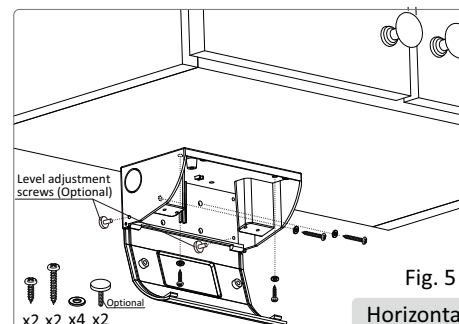

Fig. 5

Horizontal

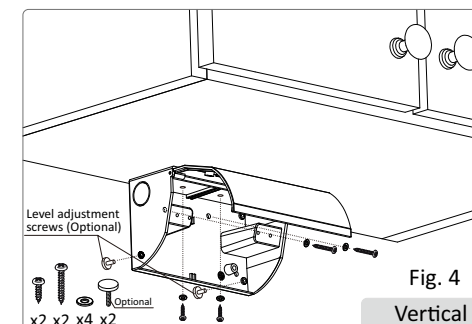

Fig. 4

Vertical

3. Pass the power cord through the installation hole and connect it to the corresponding terminals of the module (Fig. 6). Secure the module with Phillips flat head screws (Fig. 7).
4. Place the cover on top and secure it using slotted flat head screws (Fig. 8).

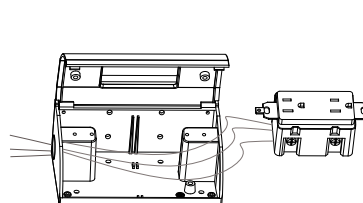

Fig. 6

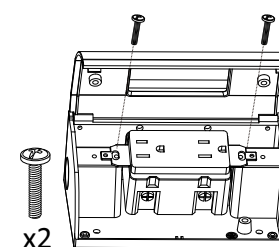

Fig. 7

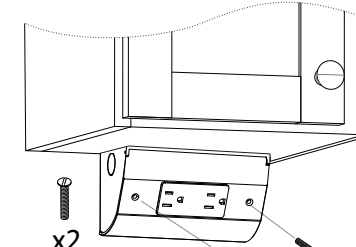

Fig. 8